

# FORTY3 VASOMULTI® NO RIM FO004BI

CE EN 997:2015

# GLOBO

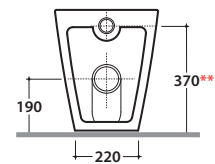
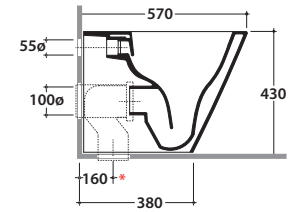
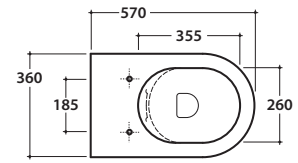

Ceramic antibacterial effect  
BATAFORM®



Bagno di Colore



SENZABRIDA®



Glazed product with  
CERASLIDE®



Scarico ottimizzato a 4/2,6 litri  
Drain 4/2,6 lt.

Cod. **FO004BI**

Floor mounted Wc No-rim 57.36 h43 cm . With adjustable water inlet/outlet MULTI. Back to wall installation. Drain 4 / 2,6 Lt. FISSAGGIOGHOST® Fixing kit included. Weight 26 Kg



Seat-cover with hinge system  
to quick release



Antibacterial treatment on toilet seats  
in shiny white

Cod. **FOR20BI**

Removable duroplast seat-cover with soft-closing system. Weight 3,5 Kg

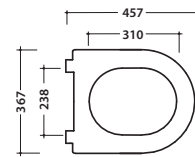
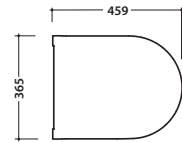

Cod. **VA092 \***

Elbow pipe for floor drain. Adjustable 6/12 cm. Weight 0,3 Kg

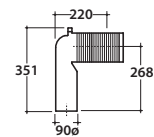

Cod. **VA093 \***

Elbow pipe for floor drain. Adjustable 13/16 cm. Weight 0,3 Kg

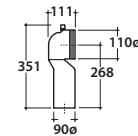

Cod. **VA094 \***

Elbow pipe for floor drain. Adjustable 17 / 21 cm. Weight 0,3 Kg

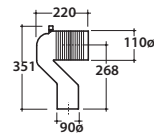

Cod. **VA086 \*\***

Eccentric pipe for water inlet 35,5/38,5cm. Weight 0,1 Kg

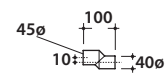

Cod. **VA076**

Pipe for wall drain 35cm.

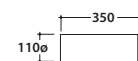

Cod. **VA132**

Flow reductor.